

3M™ Scotchkote™ Roofing
Liquid Membrane Systems



Future proof roofing solutions



About 3M

3M – Practical and ingenious solutions that help customers succeed

3M is a \$24.5 billion diversified technology company which, since 1902, has been creating innovative products that help make our world a healthier, safer and more productive one. Well known household 3M brands include Scotch[®], Post-it[®], Scotchgard[™], Thinsulate[™] and Scotch-Brite[®]. 3M employs some 75,000 people worldwide, producing thousands of innovative products for customers in dozens of diverse markets in some 200 countries. Its 45 technology platforms touch nearly every aspect of modern life.

The UK and Ireland is home to one of the largest 3M subsidiaries outside the USA, employing 3,500 people across 16 locations, including 12 manufacturing sites. Products manufactured in the UK include coated abrasives, occupational health and environmental safety equipment, adhesive tapes, industrial microbiology products, drug delivery systems, high-performance coatings, secure documents and passport scanners.

3M[™] Scotchkote[™] is the brand for our range of high performance liquid roof membrane systems. From 5 to 25 year design life, these durable and versatile systems are suitable for most roof substrates. 3M is also a single source supplier of full built up warm roof systems when compliance with Part L of Building Regulations is required.

3M[™] Scotchkote[™] Liquid Coatings are manufactured to ISO 9000 Quality Management Systems and ISO 14000 Environmental Management Systems.

Contents

Page 2	Scotchkote Roofing Systems
Page 3	15 and 25 Year Flat Roof Systems
Page 4	15 and 20 Year Pitched Roof Systems
Page 5	10 Year Flat and Pitched Roof System
Page 6	10 Year Flat and Pitched Roof Systems - Water Based
Page 7	5 Year Flat and Pitched Roof System
Page 8/9	Full Built Up Warm Roof System
Page 10	Emergency Repair System
Page 10	Cladding Refurbishment System
Page 11	Insulation
Page 12/13	Roofing System Essentials
Page 14	Roofing Systems Index
Page 14	Which Primer?
Page 15	Roofing Systems Estimating Guide
Page 16	A Scotchkote Roofing Case Study
Page 17	3M Roofing System Warranties



3M™ Scotchkote™ Roofing Systems

The Scotchkote roofing range of liquid membrane systems waterproof a wide range of roof surfaces, providing Life to First Maintenance of 5 to 25 years depending on the system chosen.

This product range includes systems based on aliphatic hydrocarbon polymers, flexible acrylic resins and moisture triggered polyurethanes.

These cost effective and versatile roofing systems are easily applied using brush and roller with spray grades available. Once cured, they form a seamless, elastic skin which permits substrate movement, does not embrittle and retains flexibility throughout its life span. The systems have excellent adhesion to most types of existing roof substrate negating the requirement to strip off existing materials and send them to expensive land fill as waste.

3M™ Scotchkote™ Liquid Coatings are manufactured to ISO 9000 Quality Management Systems and also ISO 14000 Environmental Management Systems.

Feature & Benefits

- Wide choice of systems - Life to first maintenance of 5 to 25 years
- Flat & Pitched roof systems - Plus gutter relining systems
- Warm Roof Systems able to comply with Part L
- Flame free systems
- Brush / Roller application - Allows detailing in complex areas
- Totally seamless finish - No seams or joints for potential leaks
- UV resistant - Will not embrittle and crack in sunlight
- Flexible - Accommodates climatic & structural movement
- Overcoatable - Enabling extension to design life of previously coated roof
- Suitable for most roof substrates



Seamless



Gutters

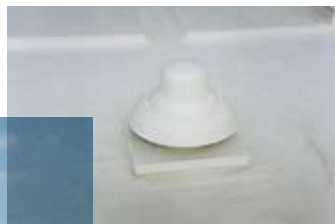

Our Service includes...

- Core sample analysis
- Thermal analysis
- Recommended course of action
- Recommended waterproofing system
- Tapered insulation design
- Detailing recommendations
- Recommended approved contractors



15 & 25 Year Flat Roof Systems

3M™ Scotchkote™ Roofing 15 and 25 Year Life to First Maintenance systems for flat roofs comprises 3M™ Scotchkote™ Roofing Poly-Tech EC 661 embedment coat and 3M™ Scotchkote™ Roofing Poly-Tech UV 662 finish coat, fully reinforced with 3M™ Scotchkote™ Roofing Premier Reinforcing Mat 050 (15 year) or 3M™ Scotchkote™ Roofing Premier Plus Reinforcing Mat 055 (25 year) depending on the system chosen.

These systems are high build, moisture triggered polyurethane membranes that cure together to form a seamless, durable waterproof coating for all flat roof types.

These systems carry British Board of Agrément certification, European Technical Approval (ETA) and also an AA Fire rating to BS 476 Part 3: 1958.

Feature & Benefits

- Long term peace of mind - 15 or 25 year life to first maintenance
- Independently tested fire resistance ratings to comply with legislation
- UV resistant - Will not crack through embrittlement from sunlight
- Will not chalk - Remains aesthetically pleasing and less prone to early membrane failure
- Complex shapes easily covered - No potential failures in joints or seams
- BBA certification - Independent accreditation and test data
- Single pack formulations - Less material waste and packaging
- Fully bonded to deck eliminating water tracking directly under the coating if punctured

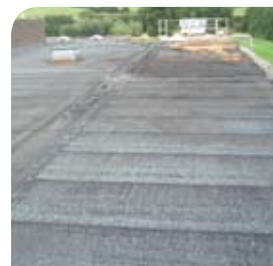

Before



Before



After



After

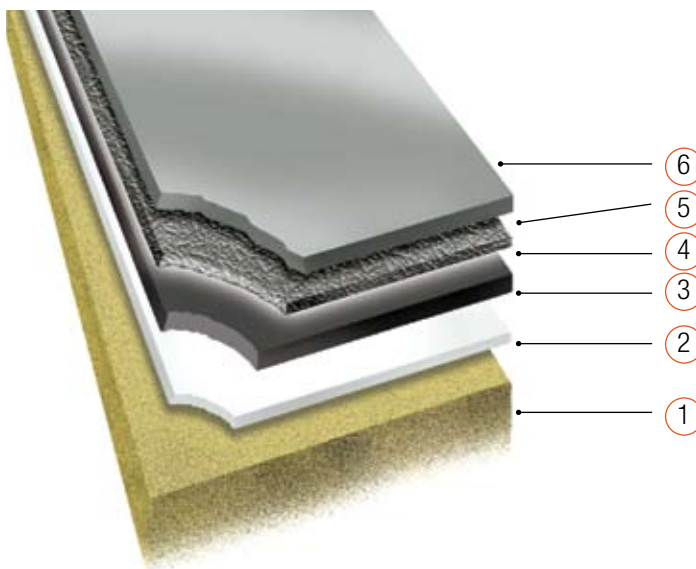

3M™ Scotchkote™ Roofing 15 & 25 Year Flat Roof System

- 1 Roof Substrate
- 2 3M™ Scotchkote™ Primer (if required)
- 3 1st Coat Scotchkote Poly-Tech EC 661
- 4 Scotchkote Reinforcing Mat
- 5 2nd Coat Scotchkote Poly-Tech EC 661 (25 Year System Only)
- 6 Finish Coat Scotchkote Poly-Tech UV 662

15 & 20 Year Pitched Roof Systems

3M™ Scotchkote™ Roofing 15 and 20 Year Life to First Maintenance systems for pitched roofs is an ideal solution for cost effective waterproofing of all types of pitched and corrugated sloping roofs with a pitch greater than 15°.

Requiring only local reinforcing to joints, seams and overlaps this high build, moisture cured system provides a cost effective and versatile system for long term waterproofing. Ideal for corrugated asbestos sheets as it encapsulates the existing substrate without the expensive requirement of full removal or over-cladding.

This high performance polyurethane system is suitable for all types of projects including new build and refurbishment and its liquid formula allows complex detailing to be simplified.

Feature & Benefits

- Long term systems - 15 and 20 year life to first maintenance
- Only local reinforcing on joint and seams required reducing application costs
- All areas of the roof encapsulated and protected against water ingress
- Simple brush/roller application - No complex or expensive tools required to apply
- Non-foaming - Reducing likelihood of air entrapment and blisters
- No need to remove and dispose of existing roof materials - Saving costs on waste
- Can be spray applied for fast application reducing disruption to normal building operations
- Independently tested - European Technical Approval (E.T.A.)



Before



After

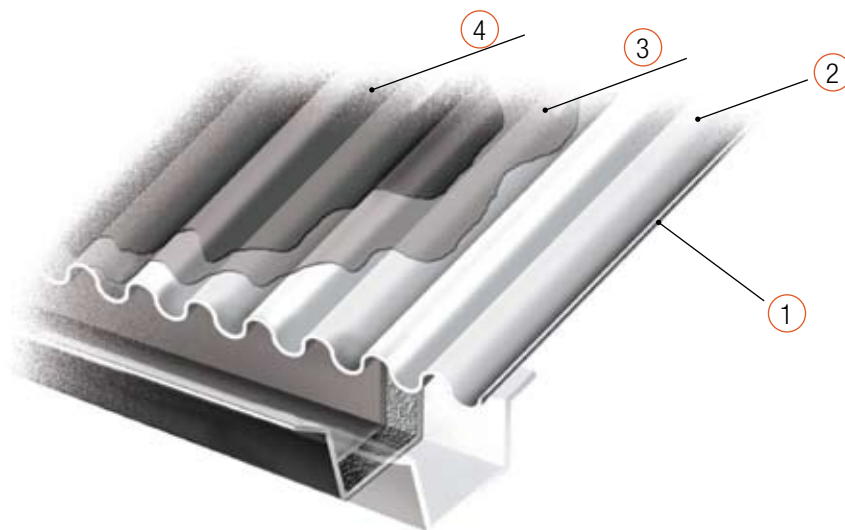

3M™ Scotchkote™ Roofing 15 & 20 Year Pitched Roof System

- | | |
|--|---|
| ① Roof Substrate | ③ 1st Coat Scotchkote Poly-Tech EC 661 |
| ② 3M™ Scotchkote™ Primer (if required) | ④ Finish Coat Scotchkote Poly-Tech UV 662 |

10 Year Flat & Pitched Roof Winter System

3M™ Scotchkote™ Roofing Poly-Tech WG 663 is a versatile, multi-purpose waterproofing system with Life to First Maintenance of 10 years on both flat and pitched roof areas.

It is a solvent based, acrylic system specifically designed to be applied at low temperatures to a wide variety of existing roof substrates including asbestos, concrete, bituminous felt, asphalt and metal.

Application is simple requiring only brush or roller, two coats with full reinforcing on flat roofs areas and only local reinforcing on pitched roof areas. This material can also be spray applied making it a good choice for cost effective waterproofing.

Feature & Benefits

- 10 years life to first maintenance - Extended with just a clean and additional coat at end of design life
- Low temperature application - Can be applied nearly all year round
- Ideal for asbestos encapsulation negating the need to remove or over-clad existing roof sheets
- No requirement to remove most existing substrates meaning reduced landfill costs and waste
- Single pack formulation - Easy application with minimal preparation
- Good adhesion to most substrates without a primer
- Fire Resistant - Tested to BS476 Part 3:1958 - AA rating
- Low weight loading - Reduces stress on roof structure



Before



Before



After



After

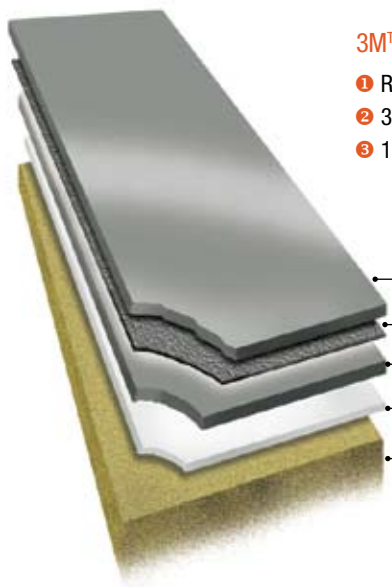

3M™ Scotchkote™ Roofing 10 Year Winter Flat Roof System

- 1 Roof Substrate
- 2 3M™ Scotchkote™ Primer (if required)
- 3 1st Coat Scotchkote Poly-Tech WG 663
- 4 3M™ Scotchkote™ Roofing Premier Reinforcing Mat 050
- 5 2nd Coat Scotchkote Poly-Tech WG 663

10 Year Flat & Pitched Water Based Systems

3M™ Scotchkote™ Roofing offer a range of three water-based waterproofing systems with Life to First Maintenance of 10 years. These acrylic, VOC free systems are low odour and like all Scotchkote liquid roofing systems, being water vapour permeable they allow damp substrates to breathe without any loss of adhesion.

3M™ Scotchkote™ Roofing Poly-Tech 665 comes in a range of colours to provide long term waterproofing to both flat and pitched roof areas. Shower resistant in 30 minutes, it can be applied with minimal disruption to the buildings function, with brush or roller.

3M™ Scotchkote™ Roofing Poly-Tech 658 is specially designed for roller or spray application making it ideal for large flat or pitched roofs. Applications by large capacity airless spray equipment make this material a cost effective solution especially for the encapsulation of asbestos sheeting.

3M™ Scotchkote™ Roofing Poly-Tech RG 600 is a high performance polymeric coating developed to provide solar reflectivity for flat and pitched roofs. It is unaffected by extreme levels of ultra violet light and will remain flexible at temperatures as low as -30°C. This system is water-based and VOC free and provides a micro porous membrane allowing the building to breathe.

Feature & Benefits

- Water based formulation - VOC free
- Low odour so can be used in sensitive areas of application
- UV stable - Not affected by sunlight
- Water vapour permeable allowing building to breathe and reducing moisture build up
- Spray grade available for fast application and reduced labour costs
- Choice of colours to match existing building aesthetics
- Shower proof in 30 minutes reducing any exposure to water ingress during application
- Fully waterproof in 2 hours allowing multiple coats in one day



Before



Before



Before



After

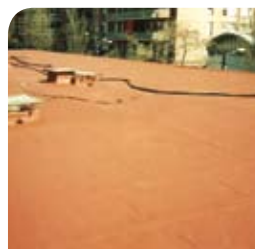

After



After

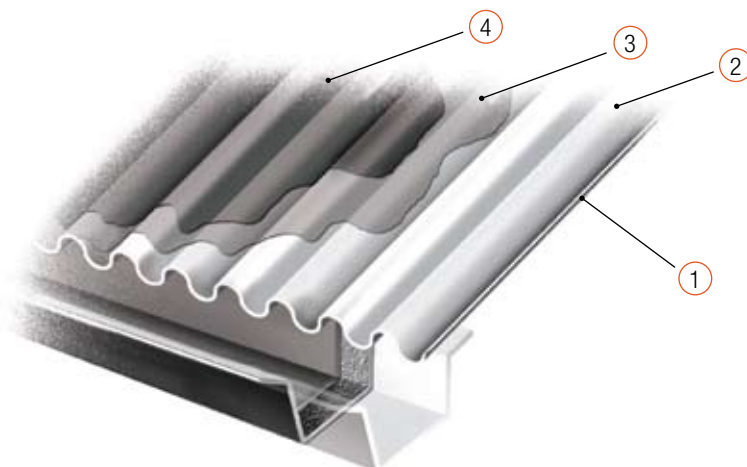

**WATER
BASED**

3M™ Scotchkote™ Roofing 10 Year Water Based Pitched Roof Systems

- 1 Roof Substrate
- 2 3M™ Scotchkote™ Primer (if required)
- 3 1st Coat Scotchkote Poly-Tech
- 4 Finish Coat Scotchkote Poly-Tech

5 Year Flat & Pitched Roof System

3M™ Scotchkote™ Roofing Poly-Tech LS 657 is a fibre reinforced acrylic multi-purpose waterproofing system providing cost effective refurbishment of all roof types. Its formulation allows application during falling rain and down to temperatures of 0°C (32°F).

Applied to most existing substrates with excellent adhesion this system offers a Life to First Maintenance of 5 years. Carrying an AA fire rating and supplied ready to use this material is non-bituminous and requires minimal surface preparation. It does not require a primer on most surfaces making this a very economical waterproofing system.

Feature & Benefits

- Economical System - 5 years life to first maintenance
- Non-bituminous
- Fibre reinforced giving excellent crack bridging capabilities
- AA fire resistance rating from independent testing
- Minimal surface preparation - Just clean and apply
- Low temperature application - Suitable for use all year round
- Single coat system - Supplied ready to use
- Simple brush / squeegee application - No complicated application requirements

**FIBRE
REINFORCED**



Before



Before



After



After

Full Built Up Warm Roof System

Feature & Benefits

- Guaranteed component compatibility backed by full manufacturers warranty
- Complies with part L building regulations
- High performance insulation
- Full technical support
- Tapered / Cut to fall insulation available
- Authorised contractor network
- Cold applied - no hot works

3M™ Scotchkote™ Poly-Tech Preparation Membrane 668

3M™ Scotchkote™ Roofing Insulation Fully bonded to the vapour control layer using 3M™ CR-20 Polyurethane Insulation Bonding Adhesive

3M™ Scotchkote™ Roofing Poly-Tech Vapour Control Layer 667 Fully bonded to substrate using 3M™ ScotchWeld™ Neoprene High Performance Contact Adhesive

Roof Substrate

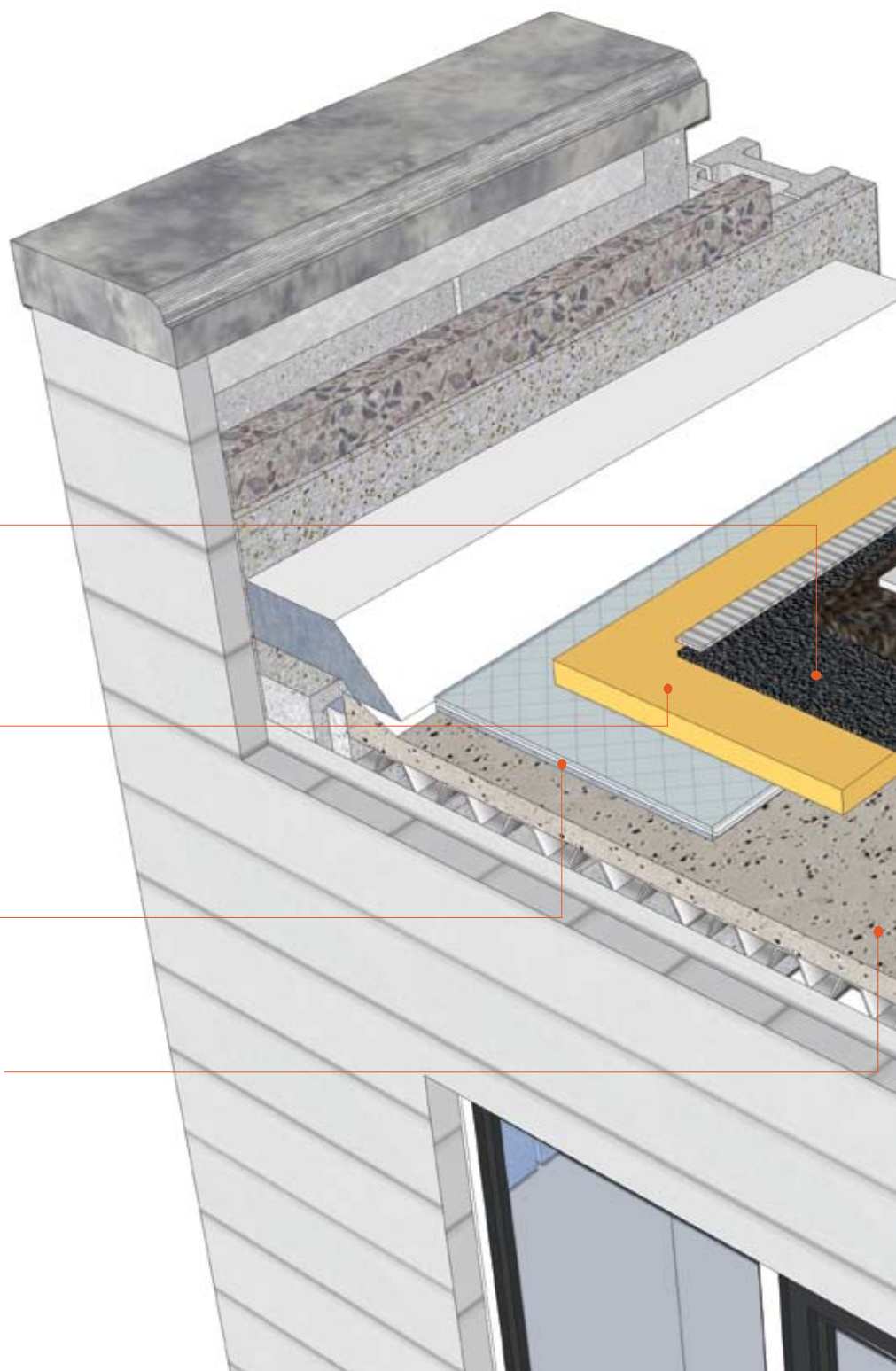

3M™ Scotchkote™ Roofing Premier 100gm Reinforcing Mat 050
10" Wide

Embed into stripe coat of chosen liquid membrane to further reinforce movement joints

3M™ Scotchkote™ Roofing Poly-Tech Liquid Membrane
First coat

3M™ Scotchkote™ Roofing Reinforcing Mat 050 or 055
(Depending on System Chosen) -1m wide
Fully embedded into base coat over the entire roof area

3M™ Scotchkote™ Roofing Poly-Tech Liquid Membrane
Second coat (if applicable)

3M™ 1900 Duct Tape

Use bondbreak tape to bridge all movement joints in carrier felt

3M™ Scotchkote™ Roofing Poly-Tech Liquid Membrane
Top coat

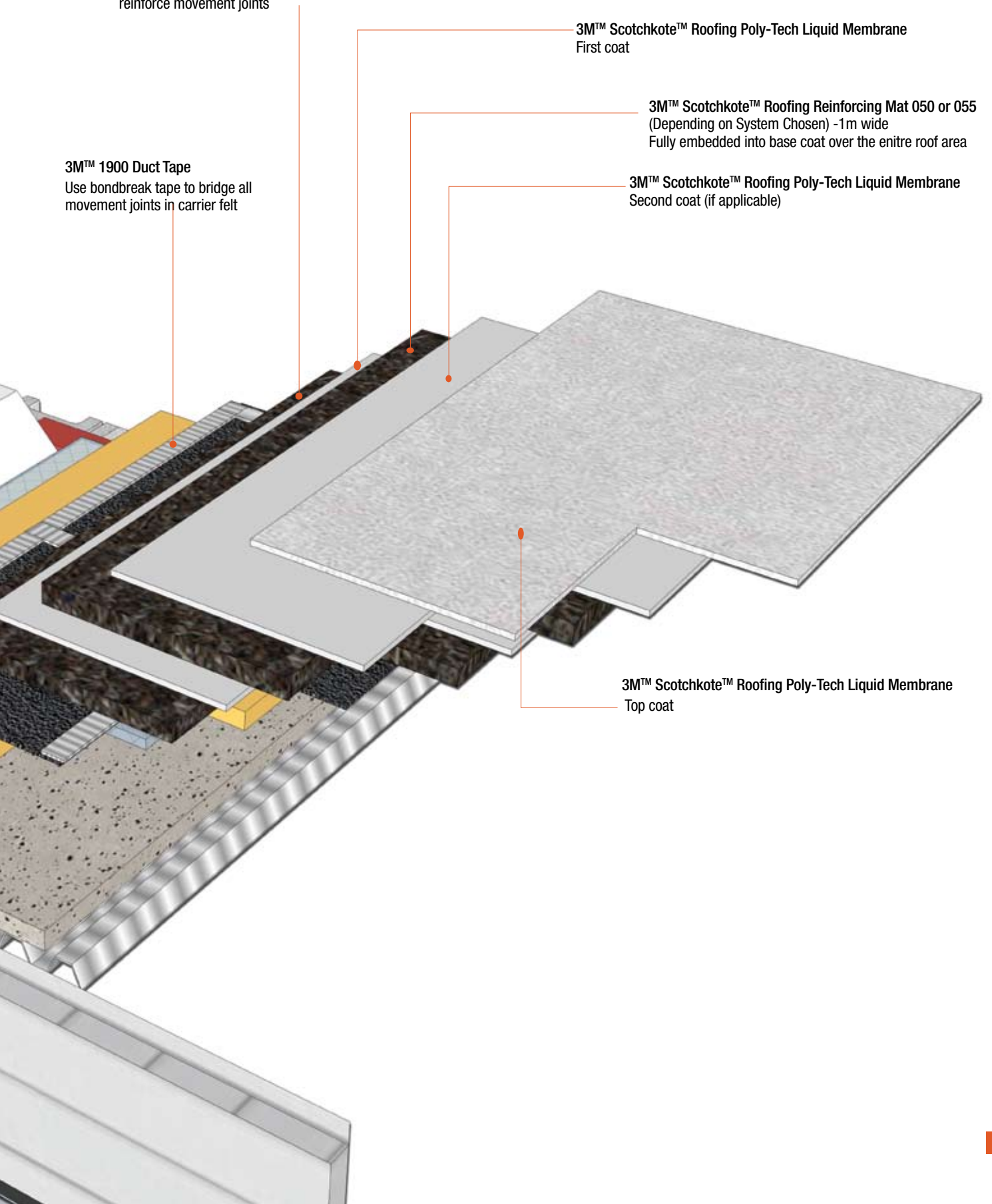

Emergency Waterproofing System

3M™ Scotchkote™ Roofing Poly-Tech AW 654 combines the very latest in polymer technology in a material that provides excellent waterproofing to any roof or gutter area regardless of weather conditions.

With simple application by brush or squeegee, Scotchkote roofing Poly-Tech AW 654 can be applied through standing water, in falling rain and at temperatures as low as 0°C. This material is fully fibre reinforced giving it ideal crack bridging capabilities and minimal surface preparation is required.

Suitable for all substrate types this material comes ready to use and is non-bituminous making it a cost effective emergency waterproofing repair solution.

Feature & Benefits

- All weather / low temperature application
- Fibre reinforced for added strength
- Seals through ponding water giving instant protection
- Minimal surface preparation required
- Excellent adhesion to most substrates without a primer
- Crack bridging capabilities for small joints and seams
- Flexible - Will withstand most climatic and building movement
- Supplied "ready to use" - Just stir to start



Before



After

Cladding Refurbishment System

3M™ Scotchkote™ Cladding Refurbishment System provides Life to First Maintenance of 10 years on all types of plastic coated metal sheeting including plastisol, PVF2 plastic and polyester powder coated. The flexibility of this moisture triggered polyurethane ensures the coating copes easily with the natural movement and flexing of the sheeting due to environmental conditions.

3M™ Scotchkote™ Roofing Urethane Coating PU 846 is UV stable and provides a tough and durable finish usually in just one coat. This material is single component and ideal for spray application on large areas. The material does not chalk and protects the structure from external exposure degradation without any loss of adhesion.

Feature & Benefits

- 10 Years Life to First Maintenance
- Single pack formulation for easy application
- Highly flexible - Will withstand normal movement within the roof sheet
- Will not chalk so remains aesthetically pleasing and less prone to early failure
- Water vapour permeable reducing moisture build up by allowing the roof area to breathe
- No priming usually required reducing application costs
- Resistant to environmental pollutants reducing carbonisation of substrate and protecting against early membrane failure
- Excellent opacity - Coverage usually in just one coat reducing labour cost of application



Before



Before



After



After

Insulation

3M™ Scotchkote™ Roofing Insulation is a closed cell, CFC and HCFC-free (zero ozone depletion), rigid polyisocyanurate foam core faced, both sides, with a perforated mineral coated glass fibre tissue.

Benefits

- Exceptionally low thermal conductivity of 0.026 W/mK
- Wide range of thicknesses available
- No requirement for roof ventilation
- Condensation within roof structure avoided
- Lightweight
- Rot proof
- Maintenance free

Tapered Insulation Systems

Tapered insulation can significantly improve water drainage from flat roof weatherproofing systems. For new build schemes the requirement to build a fall into the design of a structure is eliminated, as is the use of screeding. On existing roofs, in need of refurbishment, the system can be bonded on top of the original waterproofing to combat ponding water and eliminates the need to strip the roof to deck level.

3M™ Scotchkote™ Roofing Tapered Insulation Systems are single layer systems, which means the components are carefully bonded under factory controlled conditions and simply require adhering to the roof deck. This method of manufacture gives these boards advantages over multi-layer systems which incorporate a series of tapered components which are laid over flat “packer” boards and bonded together on site. The area that needs to be bonded can therefore be up to three times as much as the actual roof area and in addition to increasing the cost and the time involved, this also greatly increases the margin for error.

Benefits of Scotchkote Single Layer Insulation Systems

- Combats areas of ponded water
- Aids efficient traffic of water to drainage outlets
- Can reduce the structural load on a building due to standing water
- Allows easier and faster set out of the roof
- Ensures more effective and reliable adhesive bonding
- Reduces installation times
- Cuts labour requirements and adhesive costs
- Provides greater control over board tolerances

3M™ Scotchkote™ Roofing System Essentials

3M™ Scotchkote™ Poly-Tech Reinforcing Mesh 045

Honeycomb reinforcement mesh designed for use with 3M™ Scotchkote™ Roofing Poly-Tech LS 657 fibre reinforced acrylic roof membrane system.

- Standard size 25m x 25cm (80ft x 10')
- Size 50m x 50cm (160ft x 20') for larger areas
- Easy to use
- Highly flexible
- Reinforces movement joints prior to liquid membrane application
- Designed for use with 3M™ 1900 Duct Tape

3M™ Scotchkote™ Premier Reinforcing Mat 050

Chopped strand fibre glass mat for full reinforcement of all 3M™ Scotchkote™ Flat Roofing Systems and local reinforcement of 3M™ Scotchkote™ Pitched Roof Systems.

- Standard roll 100m x 1m (nominal length)
- 100gm weight per m²
- Available in 10" width for local reinforcing on pitched roofs

3M™ Scotchkote™ Premier Plus Reinforcing Mat 055

Chopped strand fibre glass mat for the full reinforcement of 3M™ Scotchkote™ Roofing Premier Plus 25 Year Flat Roof System.

- Standard roll 100m x 1m (nominal length)
- 225gm weight per m²

3M™ Scotch-Weld™ Neoprene High Performance Contact Adhesive 1357

Use to bond 3M™ Scotchkote™ Roofing Poly-Tech VCL 667 to roof substrate. Provides a long bonding range and initial strength. Adheres to many types of substrate.

- 30 minutes maximum bonding range
- Supplied in 5 gallon units
- High heat resistance
- Theoretical coverage approximately 6.6 m² / litre

3M™ Scotchkote™ Urethane Glass Coating 605

Anti-shatter system for the protection of high level glass and the reinstatement of plastic roof lights. Suitable for glass, GRP and plastics.

- UV stable
- Independently tested to BS 6206:1981 - Class A - Pass
- Retains transparency
- Excellent adhesion
- Oxidised plastics rendered clear
- Easy to use - single pack material

3M™ CR-20 Polyurethane Insulation Bonding Adhesive

Ideal for bonding insulation boards to roof decks negating any need for drilling or mechanical fixing.

- Fast curing
- High strength bond
- Less waste - does not cure in hoses
- Medium foaming - gap-fills without boards rising
- Cold applied
- FM approved
- Kit includes dispensing hoses and mixing nozzles



3M™ Scotch-Weld™ Polyurethane Construction Sealant 525

Flexible polyurethane sealant to form permanent elastic bonds. Suitable for use on a variety of materials including plastics, metals, fibreglass and wood.

- Single pack moisture cured
- Bonds dissimilar materials
- Permanently elastic
- High tensile strength
- Paintable once cured
- Fast curing
- Good adhesion to a wide variety of materials



3M™ Scotchkote™ Poly-Tech Preparation Membrane 668

SBS modified glass reinforced base with a self adhesive self edge of 100mm. Preparation membrane which acts as a stable and reinforced base to prepare the substrate for subsequent application of a 3M™ Scotchkote™ Liquid Roof Membrane System.

- Adhesion at 0°C
- Flexibility down to -20°C
- Fire performance tested to EN 1187 Parts 1, 2, 3 and 4 (BS 476: Part 3: 2004)
- No hot works
- High strength
- Easy self adhesive application

3M™ Scotchkote™ Poly-Tech VCL 667

High performance vapour control layer for use in built up roofing systems. A polyester reinforced aluminium core, coated with a rubber modified, self adhesive bitumen coating. Release film backing and fine mineral finish top coat.

- Release film protected 75mm selvedge
- Aluminium core
- Low temperature flexibility to -20°C
- Prevents water vapour penetration
- Resistant to damage and delamination
- High tensile polyester base

3M™ 8072 Rescue Tape

3M™ 8072 Rescue Tape is a 3-ply laminate, made with two layers of aluminum foil (outer layers) and one layer of polyester film (core), coated with a special cold weather acrylic pressure sensitive adhesive system which combines superior quick stick at normal temperatures with superior low temperature performance below freezing. The construction of this specialty laminate makes it highly puncture and tear resistant.

- Self adhering, self sealing
- 3 ply foil construction
- Zero permeability
- Moisture & vapour barrier to fight mildew, mould and decay
- No bleed through
- Puncture and tear resistant
- Low temperature application down to -18°C

3M™ 1900 Duct Tape

Ideal for bridging movement joints on roof substrates and roof sheets. Use to bridge joints, overlaps, seams and repairs before application of Scotchkote Liquid Roof Membrane Systems.

- High grab adhesive
- Can be applied at temperatures down to -20°C
- Tolerant of slightly damp surfaces
- Available in 50m rolls x 75mm (3") wide
- Easy to use

3M™ Scotchkote™ Primers

High performance primers compatible with the complete range of 3M™ Scotchkote™ Liquid Roofing Systems.

- Single ply primers
- Water based primers
- Metal primers
- Asbestos primers
- Adhesion Promotors
- Cut edge corrosion protection

3M™ Scotchkote™ Roofing Liquid Membrane Systems Index

Products	System Name	Roof Type	Life to First Maintenance
Poly-Tech AW 654	Emergency	N/A	N/A
Poly-Tech LS 657	Short Term	Flat / Inverted & Pitched / Sloped	5 Years
Poly-Tech RG 600	Solar Reflective	Flat / Inverted & Pitched / Sloped	10 Years
Poly-Tech 665	Summer Grade	Flat / Inverted & Pitched / Sloped	10 Years
Poly-Tech CSM 658	Summer Spray Grade	Flat / Inverted & Pitched / Sloped	10 Years
Poly-Tech WG 663	Winter Grade	Flat / Inverted & Pitched / Sloped	10 Years
Poly-Tech EC 661 / UV 662	Premier Pitch	Pitched / Sloped	15 Years
Poly-Tech EC 661 / UV 662	Premier Flat	Flat / Inverted & Gutters	15 Years
Poly-Tech EC 661 / UV 662	Premier Plus Pitch	Pitched / Sloped	20 Years
Poly-Tech EC 661 / UV 662	Premier Plus Flat	Flat / Inverted & Gutters	25 Years

3M™ Scotchkote™ Roofing Liquid Membrane Systems Which Primer?

Substrate	Poly-Tech LS 657	Poly-Tech RG 600	Poly-Tech 665	Poly-Tech CSM 658	Poly-Tech WG 663	Poly-Tech EC 661 / Poly-Tech UV 662	Urethane Coating PU 846
Asphalt	None Required	Poly-Tech BP 656	Poly-Tech BP 656	Poly-Tech BP 656	None Required	None Required	Not Applicable
Asbestos - Good	None Required	Poly-Tech BP 656	Poly-Tech BP 656	Poly-Tech BP 656	Poly-Tech BP 656	Urethane Primer FB 856	Not Applicable
Asbestos - Aged/Fried	None Required	Poly-Tech BP 656	Poly-Tech BP 656	Poly-Tech BP 656	Poly-Tech BP 656	Urethane Primer FB 856	Not Applicable
Aluminium	Epoxy Primer MC 135 / WB Epoxy Primer EA9WB	Epoxy Primer MC 135 / WB Epoxy Primer EA9WB	Epoxy Primer MC 135 / WB Epoxy Primer EA9WB	Epoxy Primer MC 135 / WB Epoxy Primer EA9WB	Epoxy Primer MC 135 / WB Epoxy Primer EA9WB	Epoxy Primer MC 135 / WB Epoxy Primer EA9WB	Not Applicable
Brick	None Required	Poly-Tech BP 656	Poly-Tech BP 656	Poly-Tech BP 656	None Required	None Required	Not Applicable
Bitumen	None Required	Poly-Tech BP 656	Poly-Tech BP 656	Poly-Tech BP 656	None Required	None Required	Not Applicable
Concrete - Dense	None Required	Poly-Tech BP 656	Poly-Tech BP 656	Poly-Tech BP 656	None Required	None Required	Not Applicable
Concrete - Porous	None Required	Poly-Tech BP 656	Poly-Tech BP 656	Poly-Tech BP 656	None Required	Urethane Primer FB 856	Not Applicable
Corroded Mild Steel	Epoxy Primer GP 120	Epoxy Primer GP 120	Epoxy Primer GP 120	Epoxy Primer GP 120	Epoxy Primer GP 120	Epoxy Primer GP 120	Epoxy Primer GP 120
Corroded Galvanising	Epoxy Primer GP 120	Epoxy Primer GP 120	Epoxy Primer GP 120	Epoxy Primer GP 120	Epoxy Primer GP 120	Epoxy Primer GP 120	Epoxy Primer GP 120
Felt	None Required	Poly-Tech BP 656	Poly-Tech BP 656	Poly-Tech BP 656	None Required	None Required	Not Applicable
Galvanising	Epoxy Primer MC 135 / WB Epoxy Primer EA9WB	Epoxy Primer MC 135 / WB Epoxy Primer EA9WB	Epoxy Primer MC 135 / WB Epoxy Primer EA9WB	Epoxy Primer MC 135 / WB Epoxy Primer EA9WB	Epoxy Primer MC 135 / WB Epoxy Primer EA9WB	Epoxy Primer MC 135	Epoxy Primer MC 135
Glass	None Required	WB Epoxy Primer GP 830	WB Epoxy Primer GP 830	WB Epoxy Primer GP 830	WB Epoxy Primer GP 830	None Required	Not Applicable
Insulation Boards Ply Faced	None Required	Epoxy Primer MC 135	Epoxy Primer MC 135	Epoxy Primer MC 135	Epoxy Primer MC 135	Urethane Primer FB 856	Not Applicable
Lead	Epoxy Primer MC 135 / WB Epoxy Primer EA9WB	Epoxy Primer MC 135 / WB Epoxy Primer EA9WB	Epoxy Primer MC 135 / WB Epoxy Primer EA9WB	Epoxy Primer MC 135 / WB Epoxy Primer EA9WB	Epoxy Primer MC 135 / WB Epoxy Primer EA9WB	Epoxy Primer MC 135	Not Applicable
Mild Steel	Epoxy Primer MC 135 / WB Epoxy Primer EA9WB	Epoxy Primer MC 135 / WB Epoxy Primer EA9WB	Epoxy Primer MC 135 / WB Epoxy Primer EA9WB	Epoxy Primer MC 135 / WB Epoxy Primer EA9WB	Epoxy Primer MC 135 / WB Epoxy Primer EA9WB	Epoxy Primer MC 135	Epoxy Primer MC 135
Previously Painted	None Required	WB Epoxy Primer GP 830	WB Epoxy Primer GP 830	WB Epoxy Primer GP 830	WB Epoxy Primer GP 830	WB Epoxy Primer GP 830	WB Epoxy Primer GP 830
Single Ply	None Required	WB Urathane Primer AP 670*	WB Urathane Primer AP 670*	WB Urathane Primer AP 670*	WB Urathane Primer AP 670*	WB Urathane Primer AP 670*	Not Applicable
Slate / Tile	None Required	WB Epoxy Primer GP 830	WB Epoxy Primer GP 830	WB Epoxy Primer GP 830	EA9WB Primer / Poly-Tech BP 656	None Required	Not Applicable

* ADHESION TEST REQUIRED PRIOR TO PROJECT COMMENCEMENT

3M™ Scotchkote™ Roofing Liquid Membrane Systems Estimating Guide

SYSTEM	PRODUCT	PACK SIZE	USED FOR	AVG RATE 1 ST COAT	AVG RATE 2 ND COAT	ACCESSORIES
Emergency	Poly-Tech AW 654	5kg / 20kg	EMERGENCY REPAIRS	1.1m ² per kg @ 500 microns (20mils) dft	N/A	N/A
5 Year Short Term	Poly-Tech LS 657	5kg / 20kg	FLAT / INVERTED ROOFS & GUTTERS	0.6 kg / m ²	0.6 kg / m ²	3M™ 1900 Duct Tape & Scotchkote Poly-Tech 045 Reinforcing Mesh
			PITCHED / SLOPED ROOFS	0.7 kg / m ²	N/A	3M™ 1900 Duct Tape & Scotchkote Poly-Tech 045 Reinforcing Mesh
10 Year Solar Reflective	Poly-Tech RG 600	20 litre	FLAT / INVERTED ROOFS & GUTTERS	1.0 litre / m ²	0.3 litre / m ²	3M™ 1900 Duct Tape & Scotchkote Premier 050 Reinforcing Mat 100gm (1m wide)
			PITCHED / SLOPED ROOFS	0.5 litre / m ²	0.3 litre / m ²	3M™ 1900 Duct Tape & Scotchkote Premier 050 Reinforcing Mat 100gm (10" wide)
10 Year Summer	Poly-Tech 665	20 litre	FLAT / INVERTED ROOFS & GUTTERS	1.0 litre / m ²	0.3 litre / m ²	3M™ 1900 Duct Tape & Scotchkote Premier 050 Reinforcing Mat 100gm (1m wide)
			PITCHED / SLOPED ROOFS	0.5 litre / m ²	0.3 litre / m ²	3M™ 1900 Duct Tape & Scotchkote Premier 050 Reinforcing Mat 100gm (10" wide)
10 Year Summer Spray	Poly-Tech CSM 658	20 litre	FLAT / INVERTED ROOFS & GUTTERS	1.0 litre / m ²	0.3 litre / m ²	3M™ 1900 Duct Tape & Scotchkote Premier 050 Reinforcing Mat 100gm (1m wide)
			PITCHED / SLOPED ROOFS	0.5 litre / m ²	0.3 litre / m ²	3M™ 1900 Duct Tape & Scotchkote Premier 050 Reinforcing Mat 100gm (10" wide)
10 Year Winter	Poly-Tech WG 663	20 litre	FLAT / INVERTED ROOFS & GUTTERS	0.8 litre / m ²	0.5 litre / m ²	3M™ 1900 Duct Tape & Scotchkote Premier 050 Reinforcing Mat 100gm (1m wide)
			PITCHED / SLOPED ROOFS	0.5 litre / m ²	0.3 litre / m ²	3M™ 1900 Duct Tape & Scotchkote Premier 050 Reinforcing Mat 100gm (10" wide)
15 Year Premier Pitch	Poly-Tech EC 661	12.5 litre	PITCHED / SLOPED ROOFS	0.5 litre / m ²	N/A	3M™ 1900 Duct Tape & Scotchkote Premier 050 Reinforcing Mat 100gm (10" wide)
	Poly-Tech UV 662			0.5 litre / m ²	N/A	
15 Year Premier Flat	Poly-Tech EC 661	12.5 litre	FLAT / INVERTED ROOFS & GUTTERS	1.0 litre / m ²	N/A	3M™ 1900 Duct Tape & Scotchkote Premier 050 Reinforcing Mat 100gm (1m wide)
	Poly-Tech UV 662			0.5 litre / m ²	N/A	
20 Year Premier Plus Pitch	Poly-Tech EC 661	12.5 litre	PITCHED / SLOPED ROOFS	0.5 litre / m ²	0.25 litre / m ²	3M™ 1900 Duct Tape & Scotchkote Premier 050 Reinforcing Mat 100gm (10" wide)
	Poly-Tech UV 662			0.5 litre / m ²	N/A	
25 Year Premier Plus Flat	Poly-Tech EC 661	12.5 litre	FLAT / INVERTED ROOFS & GUTTERS	1.0 litre / m ²	1.0 litre / m ²	3M™ 1900 Duct Tape & Scotchkote Premier Plus 055 Reinforcing Mat 225gm (1m wide)
	Poly-Tech UV662			0.5 litre / m ²	N/A	
Cladding Refurbishment	Urethane Coating PU 846	20 litre	PLASTISOL CLADDING	8.0m ² per litre @ 75 microns (3mils) dft	N/A	Scotchkote Poly-Tech 060 Knitted Reinforcing Mat
Anti-Shatter	Urethane Glass Coating 605	5 litre	GLASS, PLASTIC & GRP	4.0m ² per litre @ 150 microns (6mils) dft	N/A	N/A

All roof areas must be cleaned prior to application using an appropriate surface conditioner to remove any roof contamination. Please remember 3M™ Scotchkote™ Roofing 020 Universal Cleaner for your equipment cleaning.

3M provides the cure at Royal Berkshire Hospital

A roof at the Royal Berkshire Hospital in Reading is finally free of scaffolding after several years thanks to a roofing solution from 3M, the diversified technology company.

The flat roof covering the radiology department had been leaking, but the NHS Foundation Trust did not have the budget to replace it. Scaffolding had been put up to support a temporary roof until funds could be found to complete the job.

The hospital's facilities manager had received quotes to replace the old roof, but these were very expensive. We suggested repairing it using 3M™ Scotchkote™ Roofing Premier Plus Liquid Membrane which worked out at around half the cost of the other quotes and gives a Life to First Maintenance of 25 years.

3M™ Scotchkote™ Roofing Systems can be applied via either brush or roller. They bond with the substrate to form a seamless waterproof coating which can withstand the elements and is UV stable. The entire product offering covers a complete range of requirements, with Life to First Maintenance of between five and 25 years.

Royal Berkshire NHS Foundation Trust commented:

“This job was complicated by the amount of plant insitu on the roof, including air conditioning units, electrical cable trays and ceiling lights. This meant that a solution involving a solid membrane was not viable due to the amount of cutting that would have been required. The 3M solution was considerably more cost effective as well as offering a guaranteed seal around all of these items due to its ability to be ‘painted’ right up to them.”

As well as being competitive on cost, the fact that no heat is needed in the application process means that, unlike bituminous systems, there was no requirement for a fire marshal to comply with insurance requirements.



Before



After

3M™ Scotchkote™ Roofing System Warranties

To give peace of mind, 3M™ Scotchkote™ Roofing offer liquid membrane systems which are classified as Life to First Maintenance Systems. These waterproofing systems include between a 5 and 25 year warranty.

If the waterproofing system is applied by a **3M™ Scotchkote™ Roofing Trained Contractor** operating to a building specific 3M™ Scotchkote™ System Recommendation, Scotchkote roofing offer a product warranty of between 5 and 25 years depending on the type of system applied.

A single point warranty extending between 10 and 25 years is also available which covers the waterproofing capability of both the product and its application. This is only available provided that the waterproofing system is applied by a **3M™ Scotchkote™ Roofing Approved Contractor** operating to a building specific 3M Scotchkote System Recommendation, where a documented compliance process is followed and on payment of a premium.



3M™ Scotchkote™ Roofing Membrane clauses can be found in Section J43 of National Building Specification Plus (NBS).



3M™ Scotchkote™ Roofing are full manufacturer members of the Liquid Roofing and Waterproofing Association.



3M™ Scotchkote™ Roofing Poly-Tech EC 661 / Poly-Tech UV 662 Liquid Membrane System is certified by the British Board of Agreement (BBA) that, under normal conditions, the system will have a service life of 25 years.



The Carbon Trust Standard is awarded to organisations that measure, manage and reduce their carbon footprint.



3M™ Scotchkote™ Roofing Poly-Tech EC 661 / Poly-Tech UV 662 Liquid Membrane System carries European Technical Approval ETA-11/0202 issued by the British Board of Agreement (BBA).



3M Construction Markets

**Corrosion Protection Products
3M United Kingdom plc**

23 Standard Way Business Park
Northallerton
North Yorkshire DL6 2XA

Telephone: +44 (0)845 6028083
Facsimile: +44 (0)1609 783762 (Orders)
+44 (0)1609 788707 (Sales)

Email: roofing.cpp.uk@mmm.com

Website: www.3mconstruction.co.uk/roofing

3M Construction Markets

**Corrosion Protection Products
3M Ireland Limited**

The Iveagh Building
The Park, Carrickmines
DUBLIN 18

Telephone: +353 (0) 1 2803555
Facsimile: +353 (0) 1 2803509

Website: www.3M.ie

Please recycle. Printed in the United Kingdom.
© 3M 2011. All rights reserved.